

	Date:
	Client:
	Project:

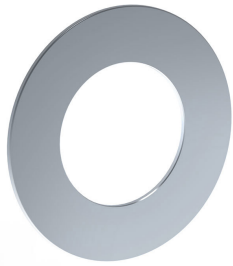

¹⁾ USA: Flow restricted to 2 gpm (7.6 l/min)



**001**

60 mm circular flange. Hole Ø30 mm.

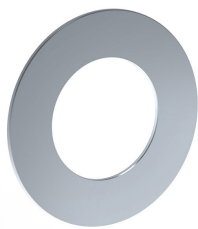
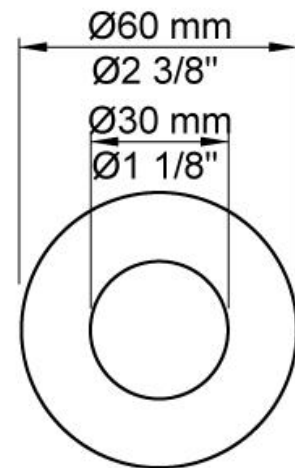
**001G**

60 mm circular flange. Hole Ø33 mm.

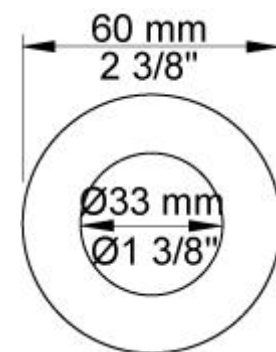
**070S**

Hand shower, hand shower holder and hose with non-return valve.

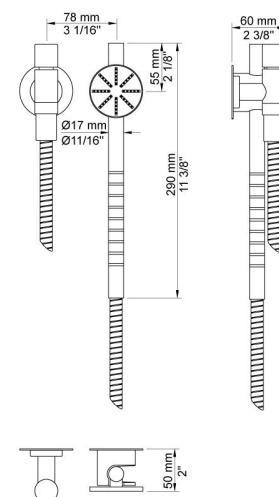

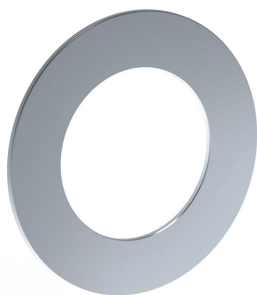
**2001**

60 mm circular flange. Hole Ø39 mm.

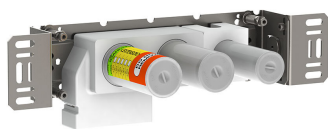
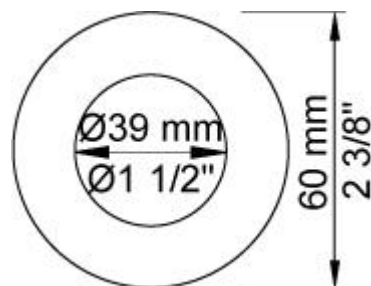
**5100**

Thermostatic mixer with fixed outlet socket. 3/4" connection to copper, steel, iron or pex pipe work.

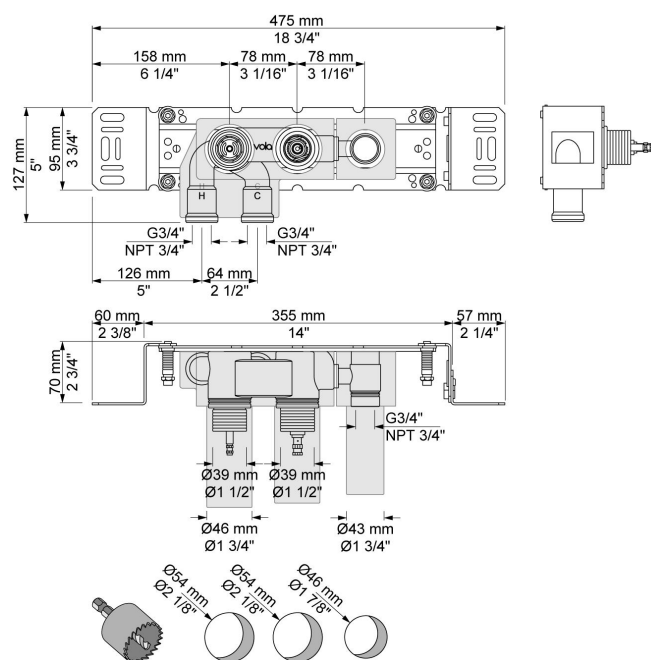
**NR51**

On/off handle for series 5000.

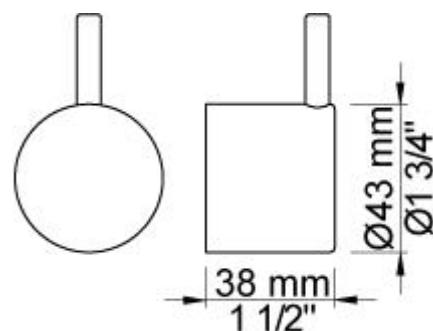

**NR52**

Thermostatic handle for series 5000.

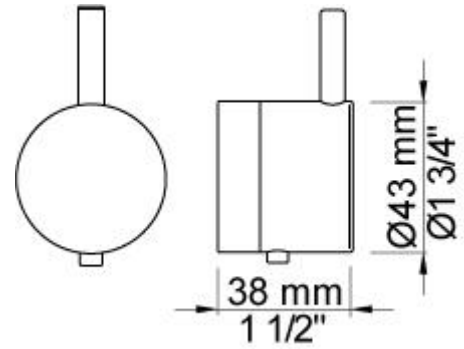
**T65**

Shower rail (Standard length 700 mm) with hand shower and hose T60.

