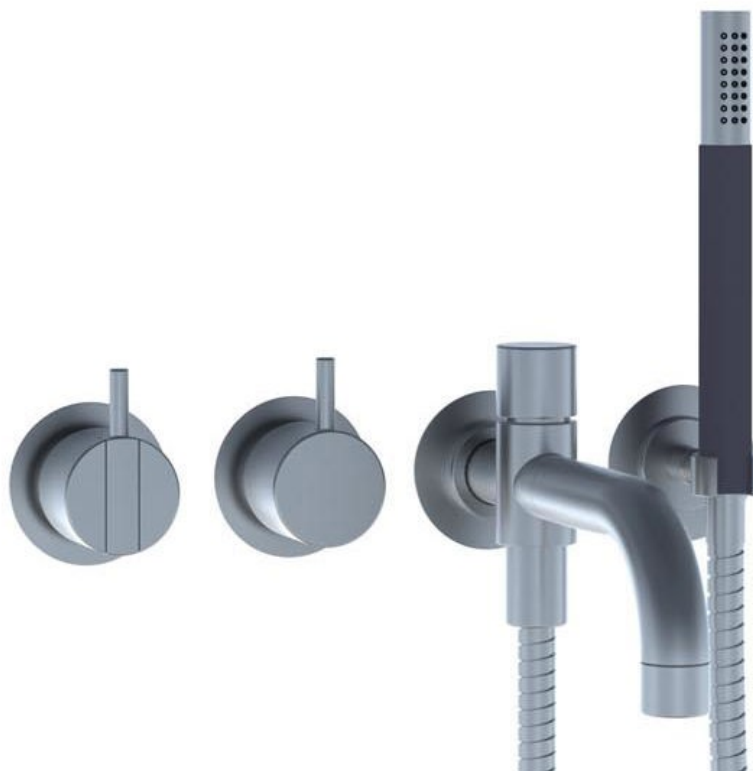

|  |          |
|--|----------|
|  | Date:    |
|  | Client:  |
|  | Project: |

**RI  
SE**

**2441DT8-051**

One-handle build-in mixer with ceramic disc technology and diverter. 2441DT8-051UP = Build-in mixer 2400N. 2441DT8-051AP = Handle NR21, handle NR24G, wall-mounted head shower 050, 200 mm bath spout with diverter for hand shower, incl. hand shower 040D, 60 mm circular flanges 001, 2 pcs. 001G, 2001, hand shower holder T8.

**Flow**

|      | Bar:    | 1.0  | 2.0  | 3.0  | 4.0  | 5.0  |
|------|---------|------|------|------|------|------|
| 040D | (l/min) | 8.7  | 12.2 | 15.0 | 17.3 | 19.4 |
| T2   | (l/min) | 5.5  | 7.8  | 9.5  | 11.0 | 12.3 |
| 050  | (l/min) | 11.6 | 16.3 | 20.0 | 23.1 | 25.8 |

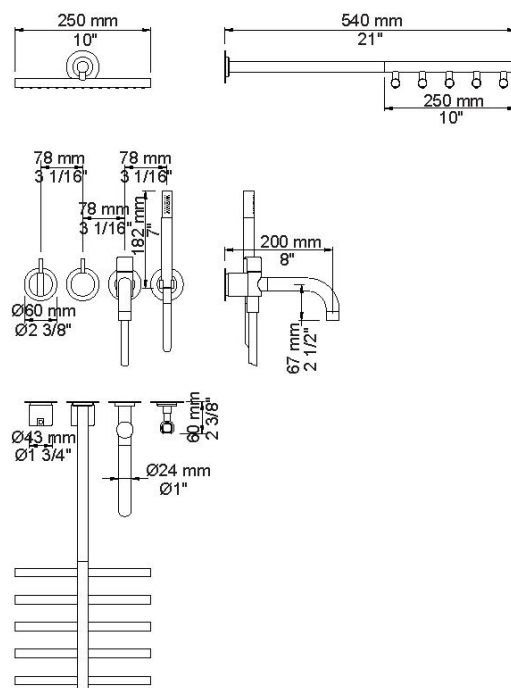
**Available in colors**

|                           |                                   |
|---------------------------|-----------------------------------|
|                           | Color 20, Brushed chrome          |
| Color 02, Grey            | Color 21, Carmine red             |
| Color 04, Light blue      | Color 25, Pink                    |
| Color 05, Orange          | Color 27, Matt black              |
| Color 06, Light green     | Color 28, Matt white              |
| Color 08, Yellow          | Color 40, Brushed stainless steel |
| Color 09, Dark grey       | Color 60, Black                   |
| Color 12, Mocca           | Color 61, Brushed black           |
| Color 14, Bright red      | Color 63, Copper                  |
| Color 15, Dark blue       | Color 64, Brushed Copper          |
| Color 16, Polished chrome | Color 65, Gold                    |
| Color 17, Gloss black     | Color 68, Silver                  |
| Color 18, White           | Color 70, Brushed Gold            |
| Color 19, Natural brass   |                                   |

**001**

60 mm circular flange. Hole Ø30 mm.

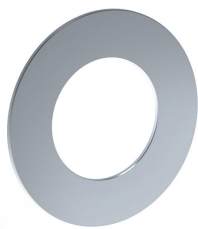
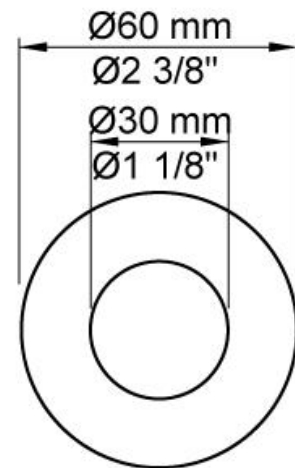
**001G**

60 mm circular flange. Hole Ø33 mm.

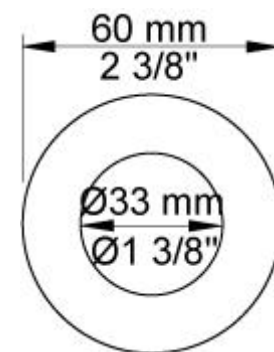
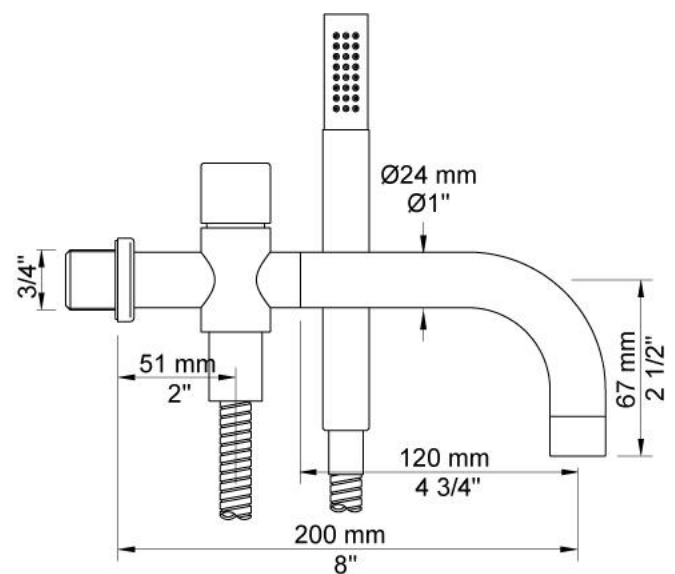
**040D**200 mm bath spout with diverter for handshower. Dimension Ø24 mm.  
Incl. hand shower T2.

**050**

Head shower, wall-mounted. Fits 200M in an existing installation if it is from the new generation of VOLA build-in fittings after 1995.

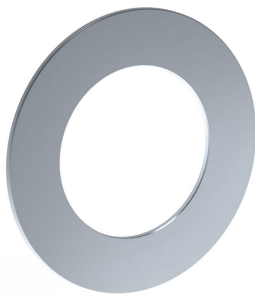
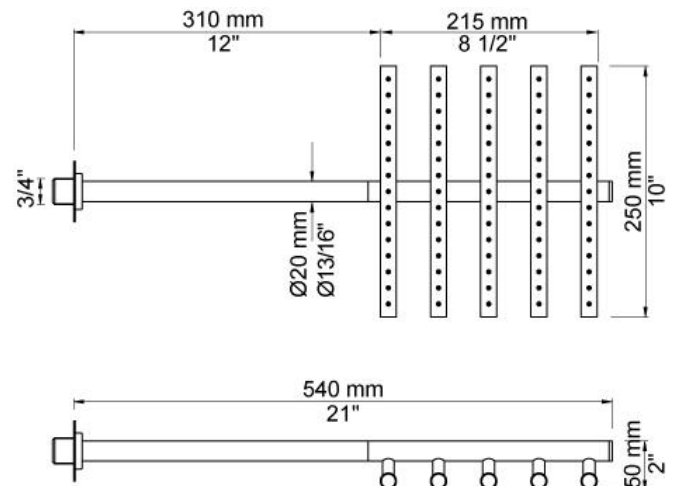
**2001**

60 mm circular flange. Hole Ø39 mm.

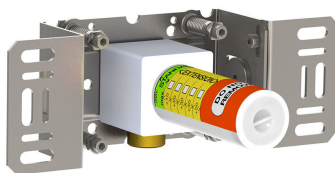
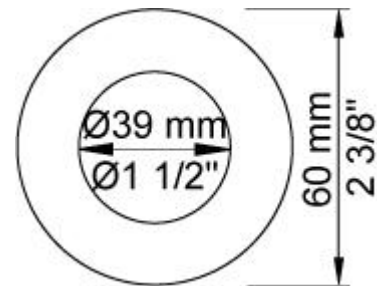
**200M**

Separate outlet socket.  
1/2" connection to copper, steel, iron or pex pipe work.

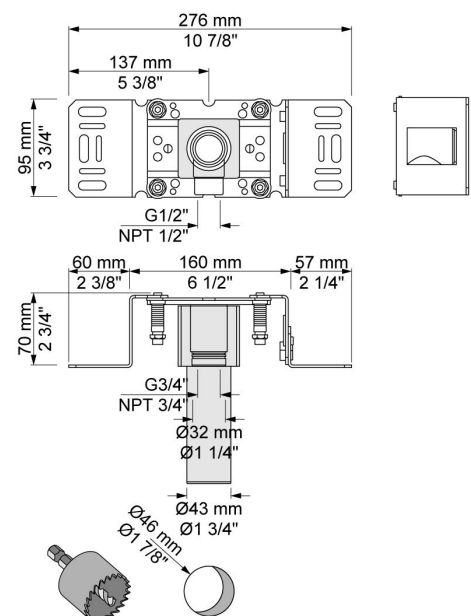

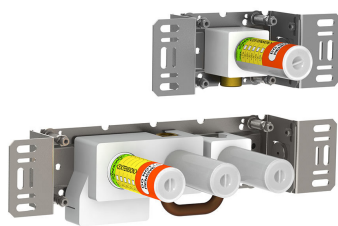
**2400N**

One-handle build-in mixer for high flow, with diverter, with one fixed outlet socket, and one separate outlet socket, 200M. ½" connection to copper, steel, iron or pex pipe work.

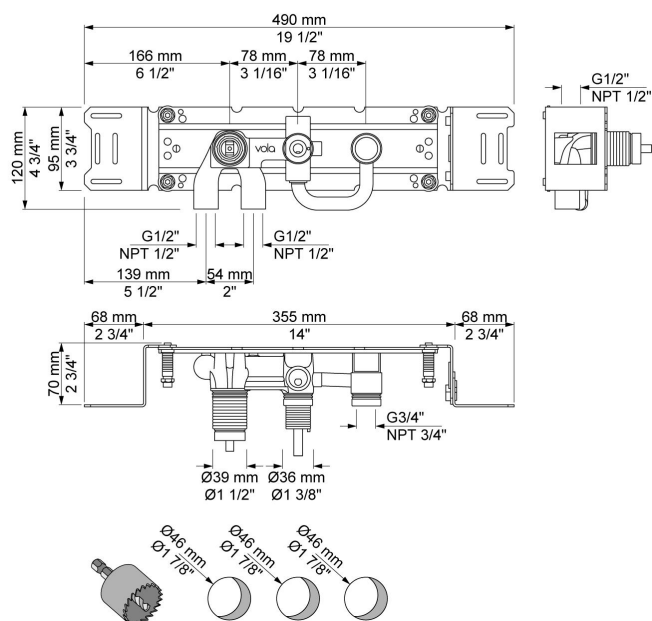
**NR21**

Operating handle for 2100, 2200, 2300, 2400 incl. variants. Ø43 mm.

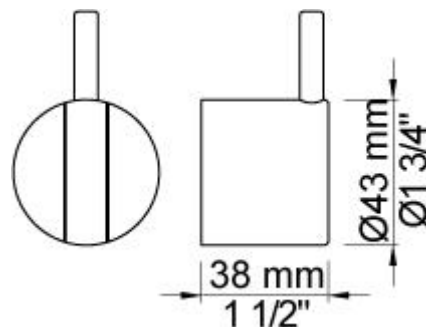
**NR24G**

Diverter handle for 2400 incl. variants. Ø43 mm. With peg in the same colour as handle (Standard).

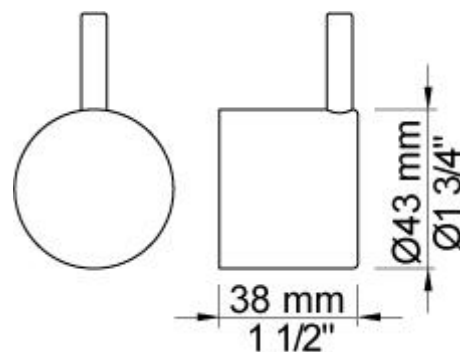



**T2**  
Hand shower with 1.5 m hose.

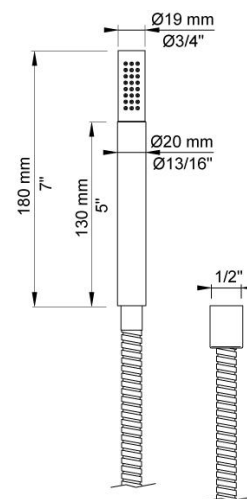

**T8**  
Hand shower holder for T2 for low mounting.

